

# PL2000 PORTABLE LATHE

FEATURES • SETUP & OPERATION  
COMPONENTS & ACCESSORIES • TECHNICAL DATA

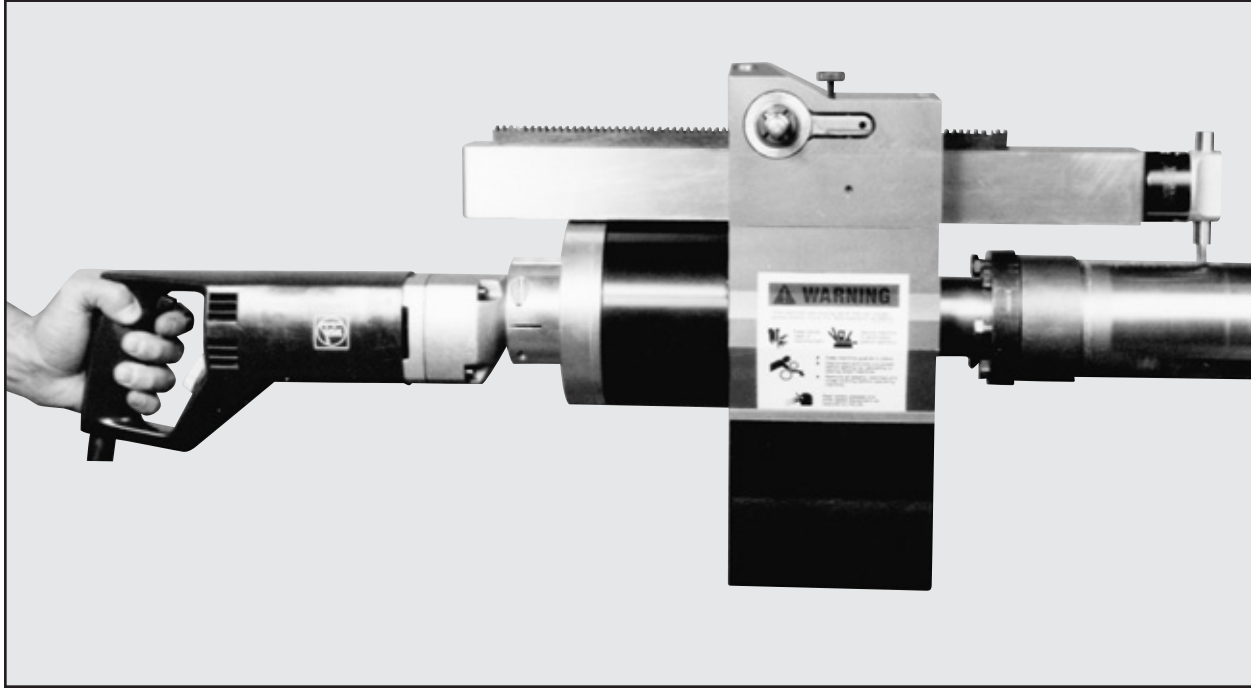

- Design Features
- Setup & Operation
- Components & Accessories
- Technical Data



**CLIMAX**<sup>®</sup>  
Portable Machine Tools, Inc.

Bringing the solution to you.

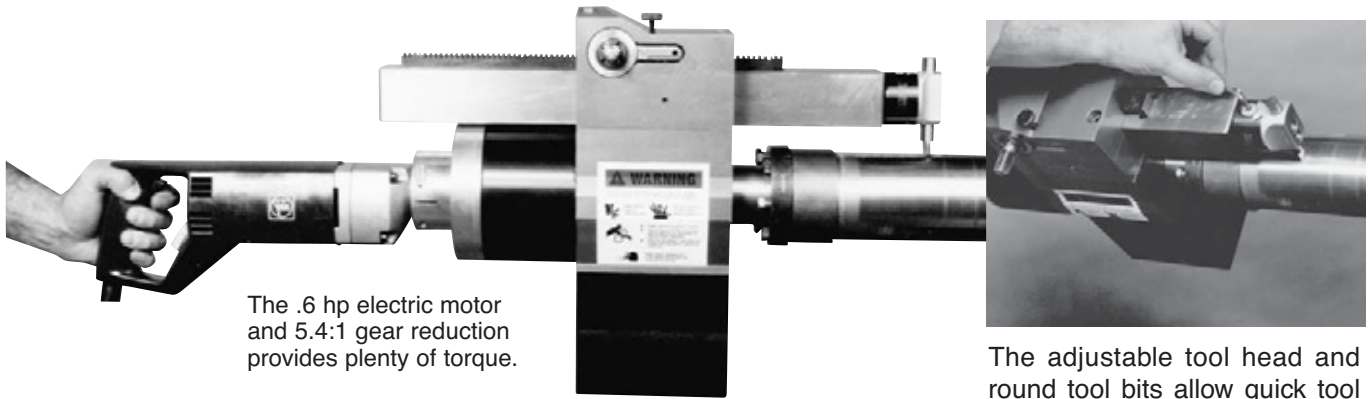

The .6 hp electric motor and 5.4:1 gear reduction provides plenty of torque.

The adjustable tool head and round tool bits allow quick tool positioning for accurate turning.

## Requires only seven inches radial clearance for confined operation

- **SHAFT END MOUNTING** The only dismantling you need to do is remove the gear or bearing to expose the end of the shaft.
- **TOOL REACH** is up to 12.5 inches (317.5 mm) from end of shaft.
- **SHAFT TURNING DIAMETER** Turn shafts from 1.5 to 9 inches (38.1 to 228.6 mm). This compact machine is able to work within a 14-inch (356 mm) diameter space at the end of the shaft.
- **INTERCHANGEABLE DRIVE MOTORS** A .6 hp (.49 kW) electric and a 1.22 hp (.91 kW) pneumatic motor is available.
- **AUTOMATIC AXIAL FEED** is infinitely variable from 0 to .035 inches/rev (0.0 to .89 mm/rev).
- **QUICK SETUP** The Model PL2000 Portable Lathe can be set up by an experienced operator in less than an hour. Drill and tap four mounting holes on the end of the shaft to attach the mounting flange. The body of the machine is attached and centered and aligned in a few minutes.

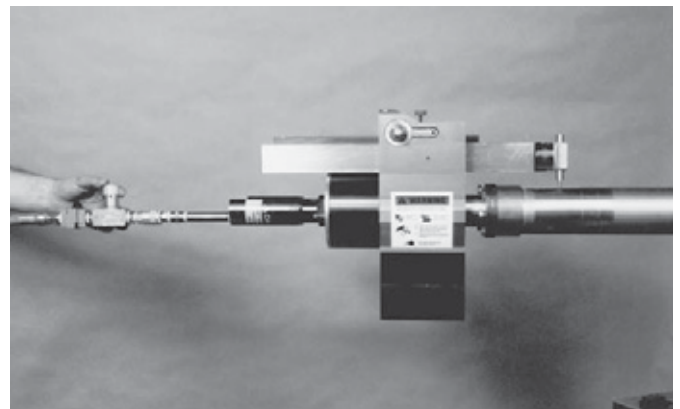

The air-powered PL2000 Portable Lathe is an excellent choice for applications where electrical sparking would create a hazardous condition.

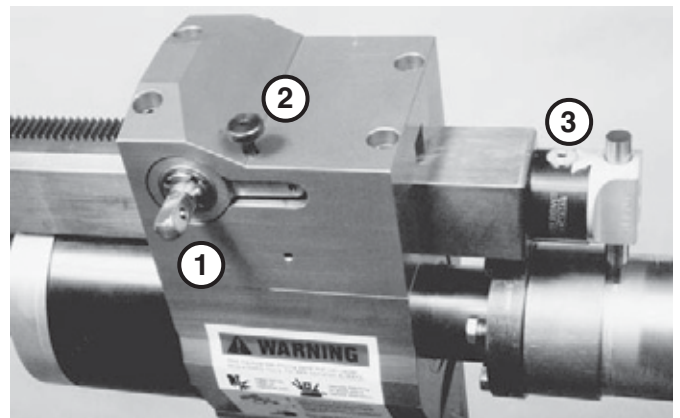

- ① Feed engagement shaft. Used with hand crank for manual positioning.
- ② Feed rate knob. Infinitely variable from 0 to .035-inch (0 to .9 mm) per revolution.
- ③ Criterion style tool head. Accurate depth adjustments in .001 inch (.0254 mm) increments.

# PL2000 Dimensions

A compact, rugged, portable lathe for on-site re-turning of small shafts or journals, the Model PL2000 Portable Lathe mounts on the end of the shaft. It is electrically or air powered. The standard machine

will re-turn shafts 1.5 to 5 inches (38.1 to 127 mm) in diameter and up to 9 inches (228 mm) with the optional spacer and counterweight assemblies. Reach from the end of the shaft is up to 12.5 inches (317.5 mm).

Overall length, electric bar fully retracted.....	27.0"	685.8 mm
bar fully extended.....	39.0"	990.6 mm
Overall length, pneumatic bar fully retracted.....	32.0"	812.8 mm
bar fully extended.....	44.5"	1130.3 mm
Overall height, without optional spacer/counterweight assy.....	13.75"	349.25 mm
Overall height, with optional spacer/counterweight assy.....	17.75"	450.85 mm
Turning reach.....	12.5"	317.5 mm
Shaft dia., max. without optional spacer/counterweight assy.....	5.0"	127.0 mm
Shaft dia., max. with optional spacer/counterweight assy.....	9.0"	228.6 mm
Shaft dia., min. without optional spacer/counterweight assy.....	1.5"	38.1 mm
Shaft dia., min. with optional spacer/counterweight assy.....	5.0"	127.0 mm

Feed rate, automatic.....	0-.035"/rev	0-.89mm/rev
	infinitely variable	
Cutter.....	modified 1/2" HSS round lathe tool bit	
Electric motor:		
115V, 60 Hz or 220V, 50Hz.....	.66 hp	.49 kW
Torque: 40 ft•lbs (53.7 N•m) at 78 rpm bar speed; Bar speed: 52-104 rpm max; Motor speed: 330-700 rpm no load, 0-420 rpm full load; variable speed control with 5 detent positions.		
Pneumatic motor.....	1.22 hp	.91 kW
(non-reversing, hp rated @ 200 rpm) Torque: 95 ft•lb (127.6 N•m) at 55 rpm bar speed; Bar speed: 0-96 rpm max; Motor speed: 375 rpm no load, 200 rpm full load; infinitely variable speed control with needle valve; Air flow required: 90 psi @ 30 ft <sup>3</sup> /min (620 kPa @ .85 m <sup>3</sup> /min);		
Net wt: pneumatic motor		
without spacers or counterweights....	94 lb	42.6 kg
with spacers and counterweights.....	111 lb	52.3 kg
Net wt: electric motor		
without spacers or counterweights....	99 lb	44.9 kg
with spacers and counterweights.....	116 lb	52.6 kg
Shipping wt.....	190 lb	86.2 kg

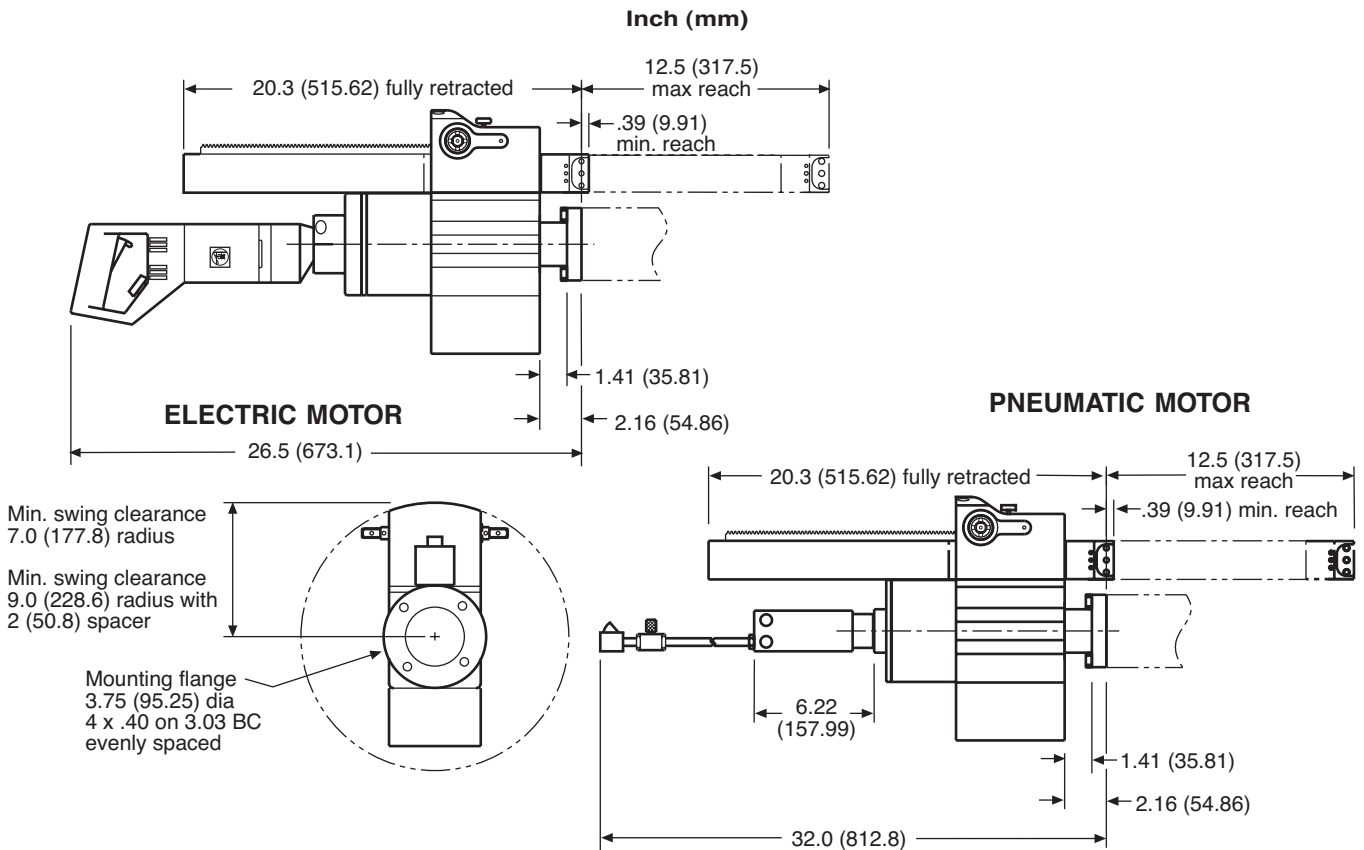

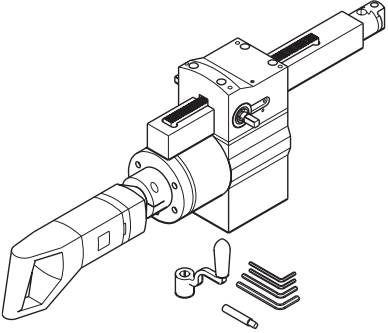
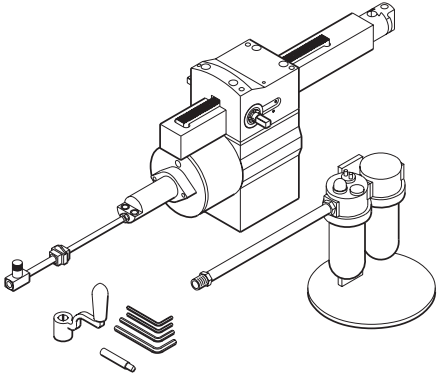
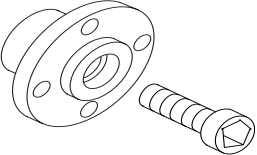
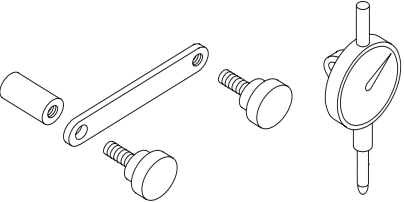
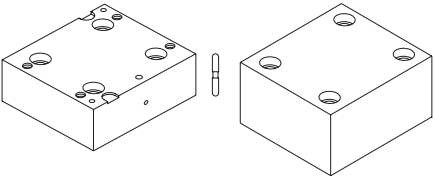
	ORDER NO.	DESCRIPTION
	31591	<b>Model PL2000 Portable Lathe, Electric 115 V, 60 Hz</b> Standard Model PL2000 complete with .6 hp electric motor, instruction manual, and tool kit. Shipped in wooden crate. Net Wt. 99 lb (44.9 kg).
	31593	<b>Model PL2000 Portable Lathe, Electric 220 V, 50 Hz</b> As above with 220 V, 50 Hz motor.
	31584	<b>Model PL2000 Portable Lathe, Pneumatic</b> Standard Model PL2000 complete with 1.22 hp (.91 kW) pneumatic motor, instruction manual, tool kit and pneumatic conditioning unit. Shipped in wooden crate. Net wt. 94 lb (42.7 kg).
	31584CE	<b>Model PL2000 Portable Lathe, Pneumatic</b> As above with CE approved pneumatic connection package with emergency air shutoff valve assembly.
	30572	<b>Single Bolt Mount Adapter</b> Allows attachment of the Model PL2000 to the end of the shaft with one bolt. Recommended for shafts under 3.75" (95.25 mm) diameter.
	30407	<b>Dial Indicator Assembly</b> Attaches to tool head for accurately aligning the machine.
	31590	<b>Spacer Assembly</b> Spacer and counterweight assembly. Allows the Model PL2000 to turn 5" to 9" (127 to 228 mm) diameter shafts. Includes all mounting hardware.

PL2-.1M1104

#### Corporate Headquarters

Climax Portable Machine Tools, Inc.  
 2712 E. Second Street, P.O. Box 1210  
 Newberg, Oregon 97132 USA  
 Worldwide Telephone: 503.538.2185  
 USA Toll-Free: 800.333.8311  
 Fax: 503.538.7600  
 Email: info@cpmt.com

#### European Headquarters

Climax GmbH  
 Willi - Bleicher - Strasse 11  
 52353 Düren, Germany  
 Telephone: (+49) (0) 2421.9177.0  
 Fax: (+49) (0) 2421.9177.29  
 Email: info.de@cpmt.com

#### Houston Sales Office

Climax Portable Machine Tools, Inc.  
 16823 Highway 35  
 Pearland, TX 77581 USA  
 Telephone: 281.469.0429



CLIMAX®  
 Portable Machine Tools, Inc.

[www.cpmt.com](http://www.cpmt.com)